



Read these instructions carefully before operating the machine and ensure they are kept accessible at all times!



1. General information

- 1.1. **GRÜN** Propane gas hand torches for liquid gas are made for tasks such as drying or finishing surfaces using an open flame. **WARNING: To prevent fire, surfaces should not be heated to temperatures above flashpoint. Keep suitable fire extinguishers to hand.**
- 1.2. Propane hand torches are only intended for use outdoors. Special safety measures must be put in place when used in closed rooms and there must be a constant supply of fresh air available.
- 1.3. The applicable legislation, local regulations, UVV, as well as the applicable regulations - in particular those of the construction industry's institution for statutory accident insurance for the use of liquid-gas powered appliances - should be observed. These contain specific provisions regarding the use of liquid-gas in close rooms, rooms below ground level and other areas below ground level (e.g. building site excavations etc.).
- 1.4. from a continuous noise level of 80 dB(A) upwards it is advisable to wear hearing protection and from 85 dB(A) upwards, hearing protection must be worn. Protective gloves, clothing and shoes are to be worn at all times.

2. Operation

- 2.1. The spring support No. 5 must be screwed on directly behind the extension tube bend.
- 2.2. Establish a gas connection. Use the **GRÜN** high-pressure hose 6.3 x 5 mm and medium pressure regulator 4 bar with integrated hose failure valve. For operations below ground level, special leakage protection must be used in place of the hose failure valve. Tighten the fittings with a key to make them gas-tight. To ensure full heating capacity, it is advisable to use a 33 kg gas bottle. Using an open flame to increase the evaporator performance of liquid gas bottles is prohibited. To achieve this during prolonged operations with powerful burners, we advise using a **GRÜN** gas bottle heater.
- 2.3. Close burner valve No. 8
- 2.4. Open the gas bottle valve and press the push button D (Page 3) on the hose failure valve to allow the hose to fill with gas.

- 2.5. Open burner valve No. 8 and ignite the pilot flame on the burner head with a propane gas lighter. The pilot flame is pre-adjusted. If the pilot flame is higher than 100 mm, unscrew and remove the brass cap nut No. 7 turning it anti-clockwise and adjust the pilot flame height to around 100 mm by using a flat-tip screwdriver to turn the slotted-head screw. Replace and screw the cap nut tight again by turning it clockwise.
- 2.6. To ignite the working flame, press the quick-release lever (9). The output of the working flame can be adjusted using burner valve No. 8.
- 2.7. When the quick-release lever No. 9 is released, only the pilot flame continues to burn.
- 2.8. Always stand the burner on the spring support No.5 and keep it under constant supervision when taking a work break.
- 2.9. Close the gas bottle valve and burner valve No. 8 when work is complete.

3. Maintenance

- 3.1. All parts - and those which convey gas in particular - must be examined regularly for mechanical and thermal damage.
- 3.2. Faulty parts may only be replaced by original spare parts or equivalent parts.
- 3.3. The gas-conveying parts, such as connecting hoses, valves and nozzles etc. should be protected against dirt and cleaned if required.
- 3.4. The air ducts for primary and secondary air should be kept clean.
- 3.5. Propane gas hand torches must be examined once a year by a professional to ensure that are in the proper condition.

4. Technical data

Gas type: Propane/Butane

Model	Item number Overall length in mm			Connection pressure max.	Flame head Ø in mm	Nozzle borehole	max. connected load in kg/h	Nominal heat output kW
	400	500	800					
A 25	0101	0102	0103	4 bar	32	0.6	1.037	13.3
K 35	0104	0105	0106	4 bar	35	0.7	1.411	18.1
S 45	0107	0108	0109	4 bar	45	1.1	3.485	44.6
U 55	0110	0111	0112	4 bar	55	1.4	5.645	72.2
St 65	0113	0114	0115	4 bar	65	1.8	9.331	119.4

5. Accessory parts

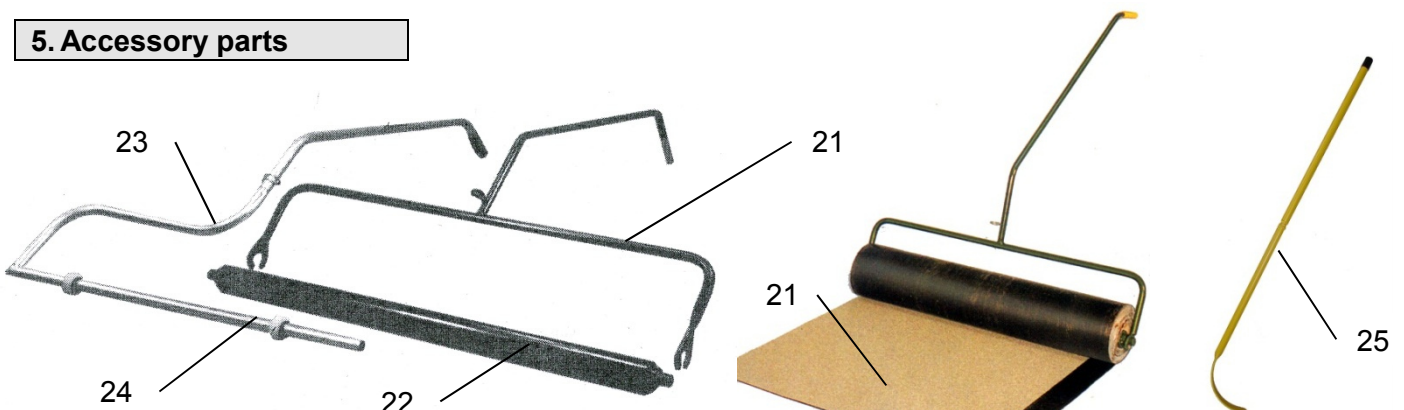

6. Individual parts / Replacement parts

Hand grip No. 6 - Detail

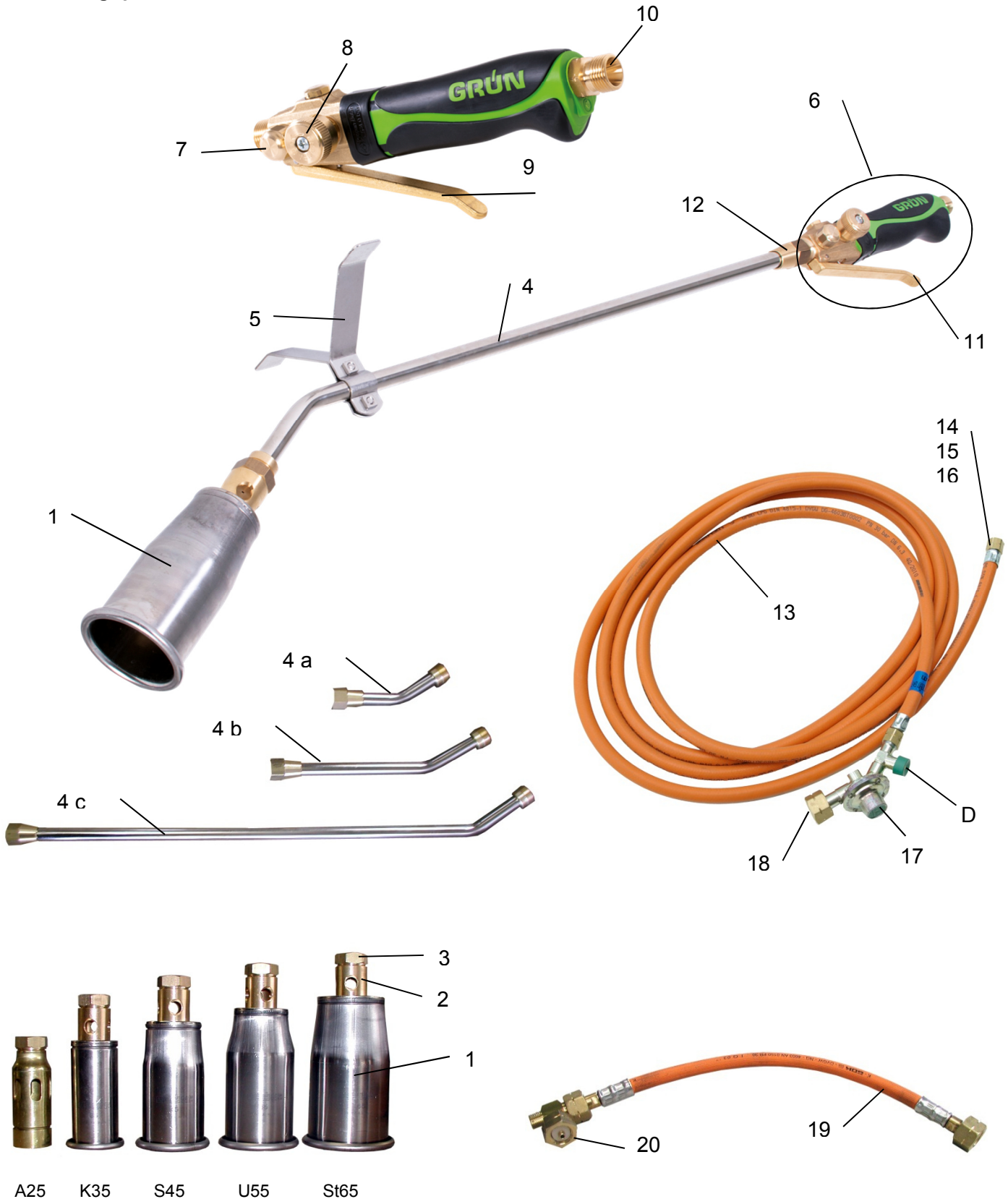

A25

K35

S45

U55

St65

Image No.	Description	Model	Item no.	Image No.	Description	Model	Item no.
1	Flame head with nozzle	A 25	0101 6000	8	Regulator valve and main shut-off valve	A25-St 65	0100 1400
		K 35	0104 6000		Hand wheel with connection screw	A25-St 65	0100 1401
		S 45	0107 6000	9	Quick-release lever with slotted spring pin	A25-St 65	0100 1300
		U 55	0110 6000	10	Hose connector piece	A25-St 65	0100 1001
		St 65	0113 6000		Throughput pipe	A25-St 65	0100 1002
2	Injector	K 35	0104 6200	11	Grip plate	A25-St 65	0100 1013
		S 45	0107 6200	12	Conical screw-in nipple	A25-St 65	0100 1004
		U 55	0110 6200	13	5m high-pressure hose with 3/8" fittings left-hand thread	A25-St 65	1526 0000
		St 65	0113 6200		10m high-pressure hose with 3/8" fittings left-hand thread	A25-St 65	1527 0000
3	Burner stand with nozzle and seal	A 25	0101 6100	14	Hose clamp	A25-St 65	1525 0004
		K 35	0104 6100	15	Hose connector	A25-St 65	1525 0002
		S 45	0107 6100	16	Union nut 3/8 "	A25-St 65	1525 0003
		U 55	0110 6100	17	Medium-pressure regulator 4 bar with		
		St 65	0113 6100		integrated hose failure valve	A25-St 65	1542 0000
	Seal for burner stand	A25-St 65	0107 6103	18	Seal for bottle connector	A25-St 65	1541 0001
4 a	Burner tube 100 mm	A25-St 65	0101 2108	19	Double bottle connector for simultaneous use of 2 gas bottles	A25-St 65	1556 0000
4 b	Burner tube 200 mm	A25-St 65	0102 2105	20	Fixing screw for filter holder for the above	A25-St 65	1555 1001
4 c	Burner tube 500 mm	A25-St 65	0103 2105		Aluminium seal	A25-St 65	1555 1002
5	Spring support complete	A25-St 65	0101 2109	21	Roofing felt applicator with roller core	A25-St 65	0319 0000
6	Hand grip complete	A25-St 65	0100 1000	22	Ball bearing-mounted replacement roller	A25-St 65	0319 1200
7	Brass cap nut	A25-St 65	0100 1005	23	Roller guide	A25-St 65	0318 0000
	Economy valve - spindle complete with O-ring	A25-St 65	0100 1100	24	Pair of replacement plastic rollers for the above	A25-St 65	0318 1000
	O-ring for the above	A25-St 65	0100 1101	25	Felt extractor	A25-St 65	0330 0000
no image available	Repair set fast-switching valve consisting of 2 x 0100 1202 as well as one of each of 1 x 0100 1203 to 1207	A25-St 65	0100 1500	26 see the following pages	Professional burner repair set	A25-St 65	0100 1600
no image available	O-ring for screw fittings and locking screws	A25-St 65	0100 1202				
no image available	Pressure spring for quick-release pin	A25-St 65	01001203				
no image available	Ball	A25-St 65	0100 1204				
no image available	O-ring for ball	A25-St 65	0100 1205				
no image available	Quick-release pin with screw fitting and O-ring	A25-St 65	0100 1206				
no image available	Locking screw	A25-St 65	0100 1207				

7. Professional burner repair set (Item no. 0100 1600)

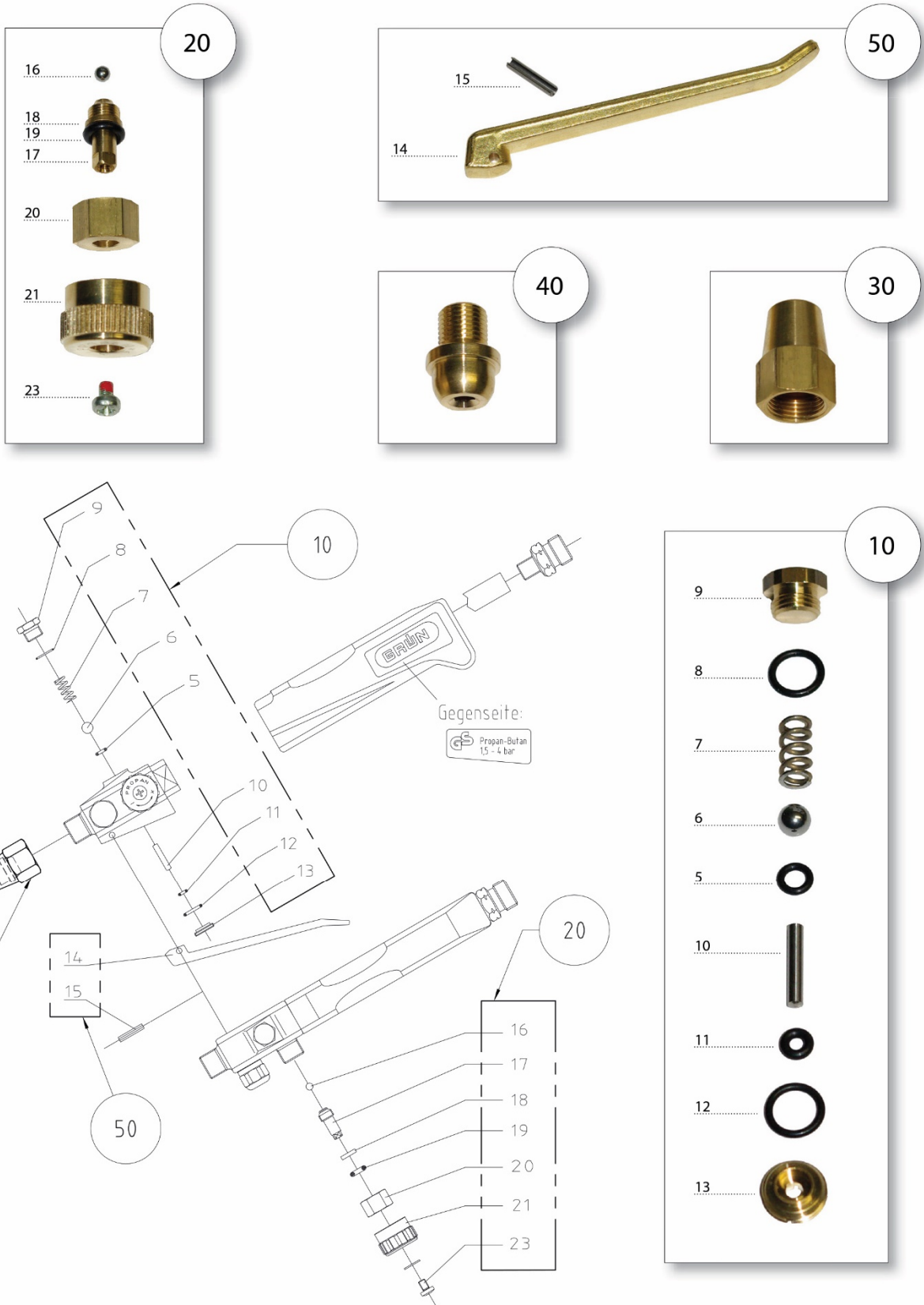

Pos. no.	Fig.	Description	Item no.
10		Repair set fast-switching valve	0100 1500
	5	O-ring 4.0 x 1.5 for ball	
	6	Ball 1/4-quick-release, for hand grip	
	7	Ball spring for hand grip	
	8	O-ring for quick-release pin	
	9	End cap for hand grip	
	10	Quick-release - pin, O-ring	
	11	O-ring 2.6 x 1.9 for hand grip	
	12	O-ring for quick-release pin	
	13	Pressure disc for hand grip	
20		Main valve complete	0100 1400
	16	Ball 0 4 spindle-seat for hand grip	
	17	Spindle for hand grip	
	18	Disc	
	19	O-ring	
	20	Spindle-ring SW14 for hand grip	
	21	Hand wheel for hand grip	
	23	Bef screw with SI coating for hand wheel	
30		Union nut for taper on burner tube	0101 2106
40		Conical screw-in nipple	0100 1004
50		Quick-release lever with slotted spring pin	0100 1300
	14	Quick-release lever (brass)	
	15	Slotted spring pin/grooved pin	



Your competent partner for roof, road and construction



GRÜN

Special Machinery Factory for Roof, Road and Construction
Siegener Straße 81-83
57234 Wilnsdorf / GERMANY

Phone +49 (0) 271 - 39 88-0
Fax +49 (0) 271 - 39 88-159
E-Mail info@gruen-gmbh.de
www.gruen-gmbh.de

